

EVERGREEN BRICK WORKS EVENT SPACE LOCATIONS

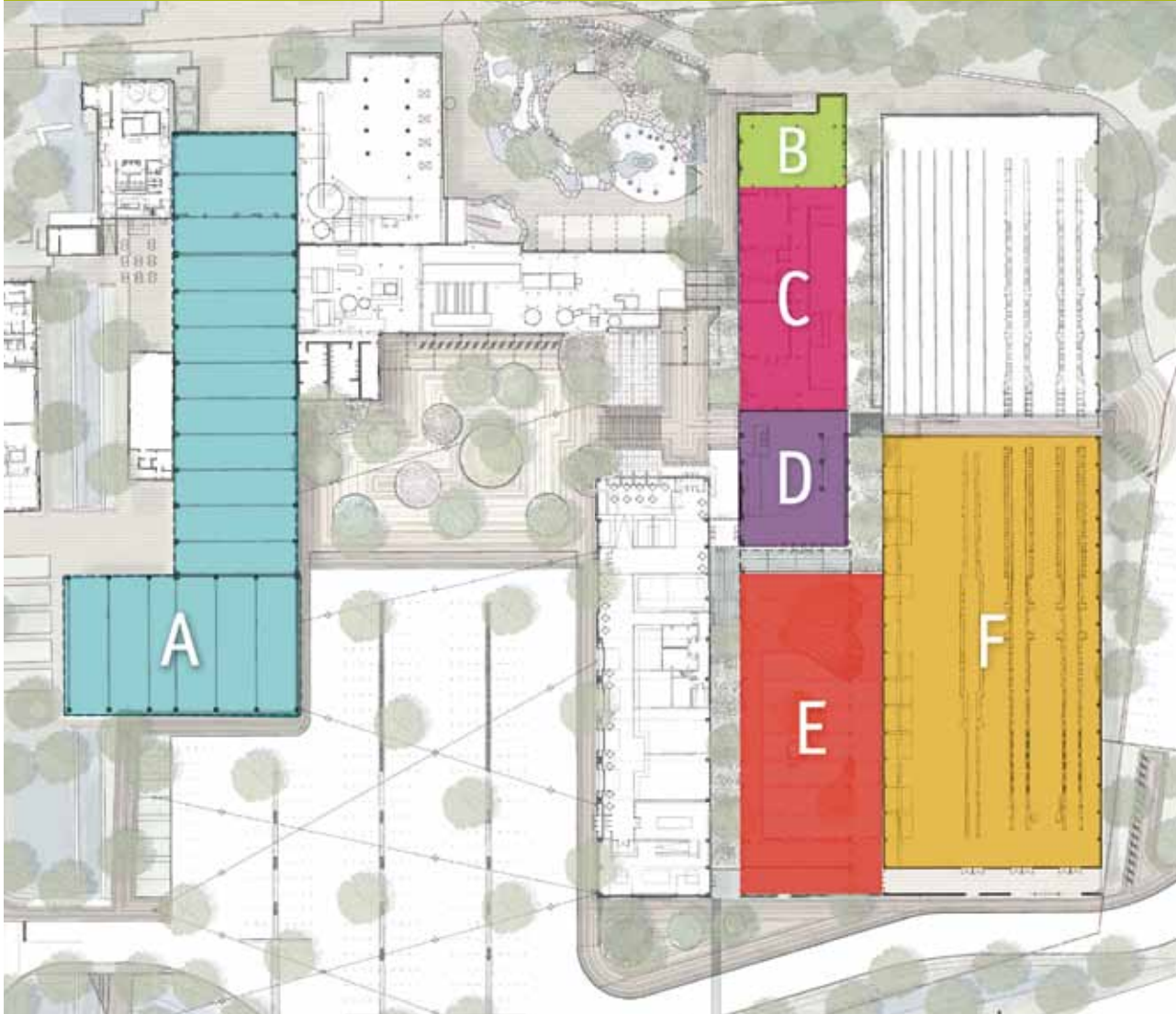

Nestled in Toronto's lush ravines in a setting of awe-inspiring heritage buildings, Evergreen Brick Works is the ideal venue for a special event. Our spaces offer various capacities, from an intimate gathering in the BMO Atrium to a 2,000-person standing reception in the Pavilions or Holcim Gallery. We also have indoor and outdoor seasonal activities such as planting, skating and team building available to third party rentals.

For more information contact
 Wendy Gamble, Events Manager
wgamble@evergreen.ca
 416-596-1495 x329



A	The Pavilions	D	Young Welcome Centre
B	BMO Atrium	E	Koerner Gardens
C	Meeting Rooms	F	Holcim Gallery

F HOLCIM GALLERY

Location

East side of site—large Kilns Building.

Space Size

11,000 sq. ft.

Occupancy Load

- Non-fixed seats: 1,200–1,500 people
- Dining: 500 people

Event Types

Special exhibits, galas, workshops, weddings, festivals, parties, fashion shows, trade shows, etc.

Description

One of the most dramatic and largest areas within Evergreen Brick Works is this 11,000 sq. ft. space. The building features long tunnel kilns and drying tunnels lit by architectural lighting. Interpretive signage explains the stories of the brick-making process. The building speaks to the rich industrial heritage of the site. Outward Bound occupies the north end of the building with a bouldering wall and outdoor climbing tower. The south end of the building will contain a gallery of large-scale contemporary art installations. The unique combination of heritage, activity and art make it a fabulous venue for events. To the west is a view of the Koerner Gardens. The space is available seasonally.

